

Rugby Manufacturing Rancher Manual

RANCHER INSTALLATION AND OPERATOR'S MANUAL



IMPORTANT!!

Read this manual thoroughly prior to installation and operation. This manual outlines the installation and operation of a Rancher platform manufactured by Rugby Manufacturing Co. This manual should be kept readily accessible for any potential operator at all times. Should you have any questions or concerns, please contact your dealer or a Rugby Manufacturing customer service representative before use.

Toll Free: 1-800-869-9162 • Office: 1-701-776-5722 • Fax: 1-701-776-6235
Visit www.rugbymfg.com for further information.

Serial Number: _____

In Service Date: _____

Rugby Manufacturing Manual Template

Table of Contents

How to Use This Manual	1
Labels	1
Reference Information	2
Serial Number Location.....	2
Torque Values Chart.....	2
General Safety	3
General Warnings	4
Assembly & Installation.....	5
Bulkhead Installation.....	5
License Plate Installation	7
Fuel and DEF Inlet Bracket Installation.....	8
Installation to Truck Frame	9
Lights and Decals	18
Maintenance & Operation.....	19

Rugby Manufacturing Rancher Manual

How to Use This Manual

This manual provides guidelines and instructions for correctly operating and maintaining your Rugby Manufacturing product. Any and all people that own and operate a Rugby Manufacturing dump trailer are recommended to read and fully understand each section in this manual. Throughout this manual, the three following types of labels will be used: danger, warning, and caution. It is imperative that all labels are obeyed, for the safety of the operator.

NOTE: This manual defines the operation and installation of 6th generation Rugby Rancher bodies. Some sections of this manual may not directly correlate with earlier generations of Rugby Rancher bodies

Labels

Throughout this manual, the three following types of labels will be used: **danger**, **warning**, and **caution**. For the safety of the operator, it is imperative that all labels are obeyed.



! DANGER

Danger: Indicate[s] a hazardous situation which, if not avoided, will result in death or serious injury.

! WARNING

Warning: Indicate[s] a hazardous situation which, if not avoided, could result in death or serious injury.

! CAUTION

Caution: Indicate[s] a hazardous situation which, if not avoided, could result in minor or moderate injury.

Rugby Manufacturing Rancher Manual

Reference Information

Serial Number

This information is required for any warranty or service inquiries, and should be recorded on the front page of this manual for easy reference.

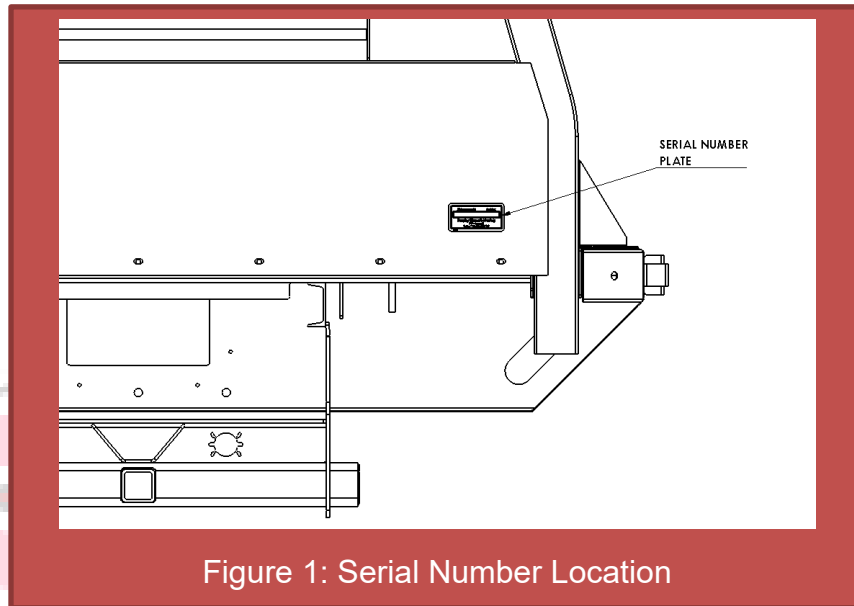

Figure 1: Serial Number Location

The serial number is located on the Front Driver's Side, on the Front of the Bulkhead, towards the cab of the Truck (**Figure 1**).

Torque Values Chart



Size	Grade 2 Torque	Grade 5 Torque	Grade 8 Torque
			
1/4-20	3-4 lb-ft	6-7 lb-ft	10-11 lb-ft
1/4-28	4-5 lb-ft	8-9 lb-ft	11-12 lb-ft
5/16-18	8-9 lb-ft	14-15 lb-ft	21-22 lb-ft
5/16-24	9-10 lb-ft	15-16 lb-ft	21-22 lb-ft
3/8-16	17-18 lb-ft	24-26 lb-ft	37-40 lb-ft
3/8-24	19-20 lb-ft	28-30 lb-ft	40-43 lb-ft
1/2-13	38-42 lb-ft	60-65 lb-ft	90-100 lb-ft
1/2-20	43-47 lb-ft	70-75 lb-ft	95-105 lb-ft
5/8-11	75-80 lb-ft	122-130 lb-ft	180-190 lb-ft
5/8-18	85-90 lb-ft	145-150 lb-ft	200-210 lb-ft
3/4-10	132-140 lb-ft	220-230 lb-ft	315-330 lb-ft
3/4-16	152-160 lb-ft	250-260 lb-ft	355-370 lb-ft

Figure 2: Torque Values Chart

Rugby Manufacturing Rancher Manual

General Safety

Installation of the Bulkhead requires two people. Avoid placing hands or other body parts in locations where they could be pinched or crushed by the components during installation.

DANGER

Bouncing or jerking of the hoist is to be avoided as it may result in component failure, injury or death.

DANGER

Do not raise or drive a raised body against another object. Doing so could result in equipment or property damage, injury or death.

DANGER

Overloading of a truck can cause truck component damage, injury or death. Never exceed the gross vehicle weight (GVW) or gross axle weight (GAW) rating of your vehicle.

Rugby

Rugby Manufacturing Rancher Manual

General Warnings

- Welding, oxy-fuel cutting, or grinding sparks can cause fuel to ignite that in turn can lead to injury or death. Always take adequate steps to avoid ignition of fuel from fuel tanks when welding, grinding, or oxy-fuel cutting during equipment installation.
- Heat from the truck's exhaust system can cause hydraulic component failure and may lead to a fire that could cause injury or death. Always install equipment in locations where heat from the exhaust system will not damage any hydraulic components.
- Malfunctioning equipment can cause property damage, injury or death. Always have faulty equipment repaired before continuing its use. Consult the manufacturer if required.
- The inadvertent shorting of the vehicle's electrical supply can cause a fire or equipment damage that could lead to injury or death. Always disconnect the vehicle battery prior to installing, servicing, or repairing electrical items.
- Damage to brake lines during equipment installation or installing bolts or equipment in such a way that the line will rub and become damaged can lead to brake failure which can cause an accident and can lead to severe injury or death. Always take adequate steps to prevent brake line damage during installation and isolate brake lines from installed equipment
- Check load making sure that rocks, equipment, or any other object will not fall off of vehicle while driving vehicle. Falling objects can cause equipment or property damage, bodily injury or death.
- Make sure all doors are closed and latched before moving vehicle. Swinging doors or falling objects can cause equipment or property damage, bodily injury or death.
- Overloading of a vehicle can cause vehicle component damage or an accident which may cause injury or death. Never exceed the gross vehicle weight (GVWR) or gross axle weight (GAWR) rating or gross combined vehicle rating (GCWR) of your vehicle.
- Not installing or operating equipment correctly can cause component damage or an accident which may cause injury or death. Always install and operate equipment in accordance with manufacturers' instructions. Read and understand this manual fully before proceeding.
- Missing or damaged decals can lead to accidents that may cause serious injuries or death.

Rugby Manufacturing Rancher Manual

Assembly & Installation

Bulkhead Installation

Tools Required: Drill, 3/8" Socket, 5/16" Socket, Torque Wrench.

- 1) There are two mounting heights for the Bulkhead:
 - a) The Bulkhead ships positioned approximately 42" height from deck to top of Bulkhead.
 - b) For taller applications, remove the Bulkhead and install the filler plate, using the Bulkhead Filler Plate Kit (2294049). Use the top row of predrilled holes to attach the filler plate to the Bulkhead and the bottom row of holes to attach the filler plate to the body.
 - i) The installation of the Filler Plate will bring the Bulkhead height to approximately 45" from the deck to the top of the Bulkhead.
- 2) Refer to [Figure 2](#) for torque guidelines.
- 3) Refer to [Figure 3](#) for Bulkhead installation bolt alignment.
 - a) Fastener hardware shown in [Figure 3](#) include (15x) 3/8-16 x 1 Grade 5 Flange Bolts (1511135) and (15x) 3/8-16 Grade 5 Flange Nuts (1540531).
 - i) Additional hardware for the Filler Plate Installation is included with the Bulkhead Filler Plate Kit (2294049).

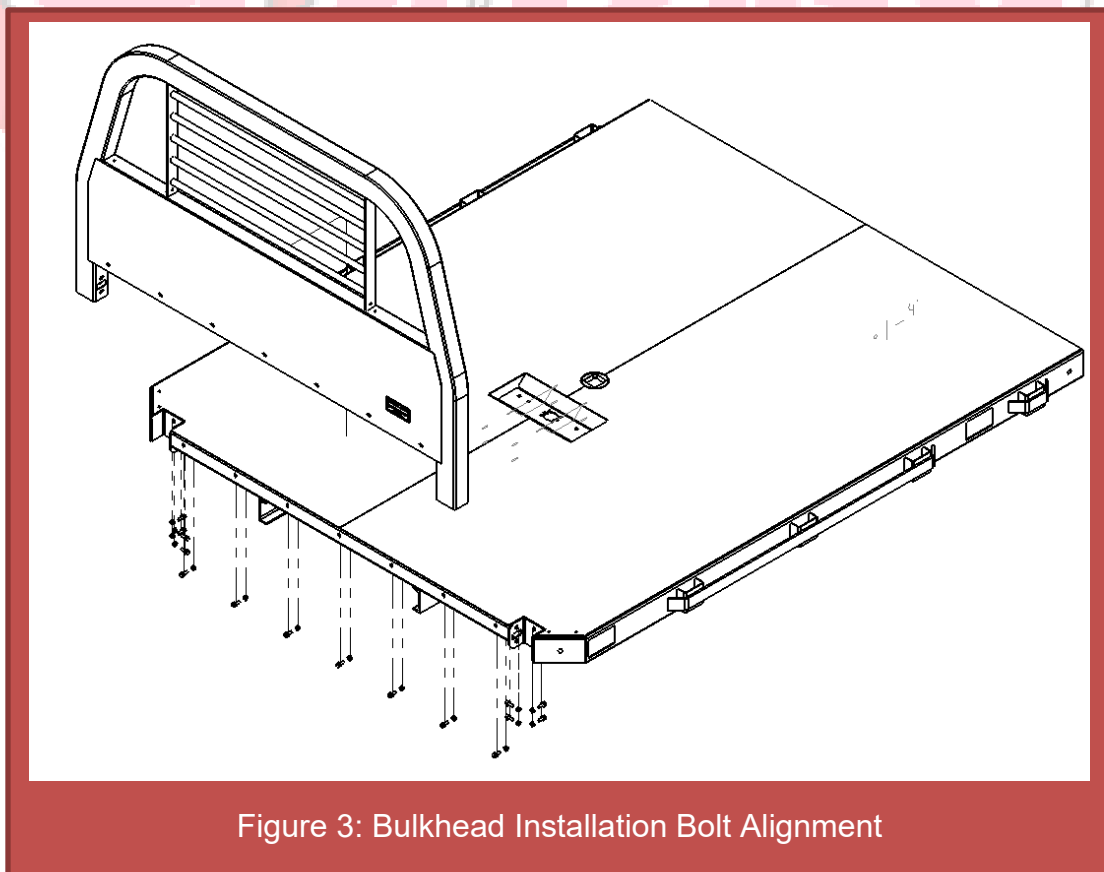

Figure 3: Bulkhead Installation Bolt Alignment

Rugby Manufacturing Rancher Manual

- 4) Install the Bulkhead Gussets after completing steps 1-3.
 - a) Position the Gusset with the slots in one flange over the predrilled holes in the flooring, and the other flange adjacent to the Bulkhead tubing as shown in Figures 4 and 5. Loosely fasten the lower flanges with (2x) 3/8-16 X 1" Grade 5 Bolts (1511135) and (2x) 3/8-16 Grade 5 Nuts (1540531).
 - b) Drill two (2x) 5/16 X 3/4" Thread Cutting Screws (1642708) through the holes/slots in the Gusset flange that is adjacent to the Bulkhead tubing, into the Bulkhead tubing. Refer to Figures 4 and 5.
 - c) Tighten all Gussets Bolts. Refer to Figure 2 for torque guidelines.

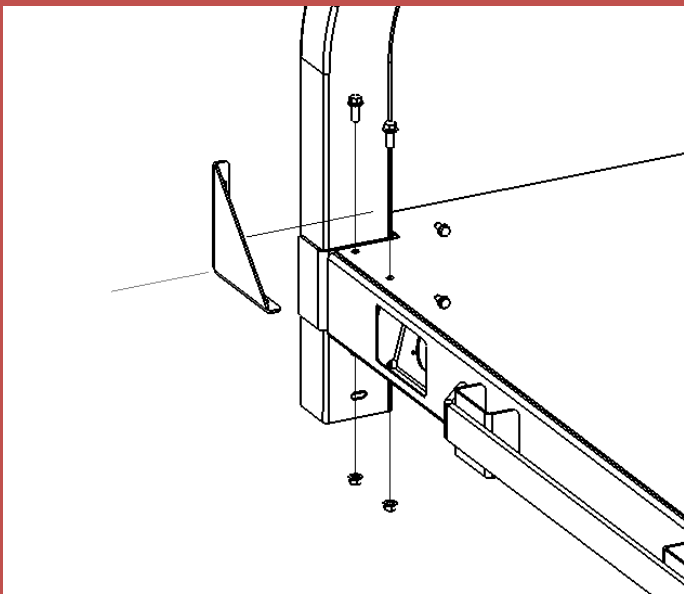

Figure 4: 84W Bulkhead Gusset Installation Bolt Alignment

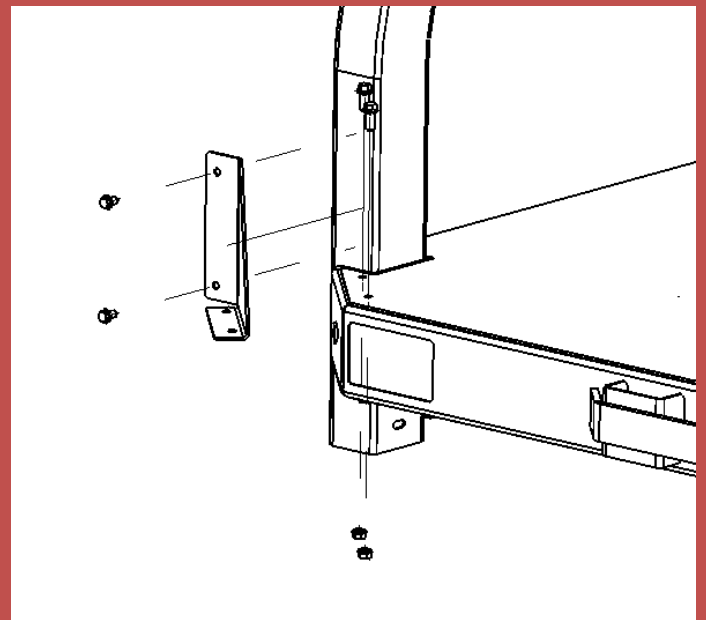

Figure 5: 96W Bulkhead Gusset Installation Bolt Alignment

Rugby Manufacturing Rancher Manual

License Plate Installation

Tools Required: 1/4" Socket, Torque Wrench

- 1) Clip the six (6x) 1/4-20 Extruded U-Nuts (2044065) over the indicated holes of the License Plate Bracket (2355004). Refer [Figure 6](#).
- 2) Position the License Plate Bracket (2355004) behind the License Plate cutout on the Rear Apron of the Platform, with the six (6x) Extruded U-Nuts (2044065) positioned under each of the 6 mounting holes on the Rear Apron.
 - a. Fasten the License Plate Bracket to the Rear Apron with six (6x) 1/4-20 X 3/4 HHC GR5 Screws (1653797) with six (6x) 1/4" Washers (1684088). Refer to [Figure 6](#).
- 3) Install the License Plate to the License Plate Bracket (2355004) with four (4x) 1/4-20 X 3/4 HHC GR5 Screws and 1/4" Washers (1684088). Refer to [Figure 6](#).
- 4) Refer to [Figure 2](#) for torque guidelines.

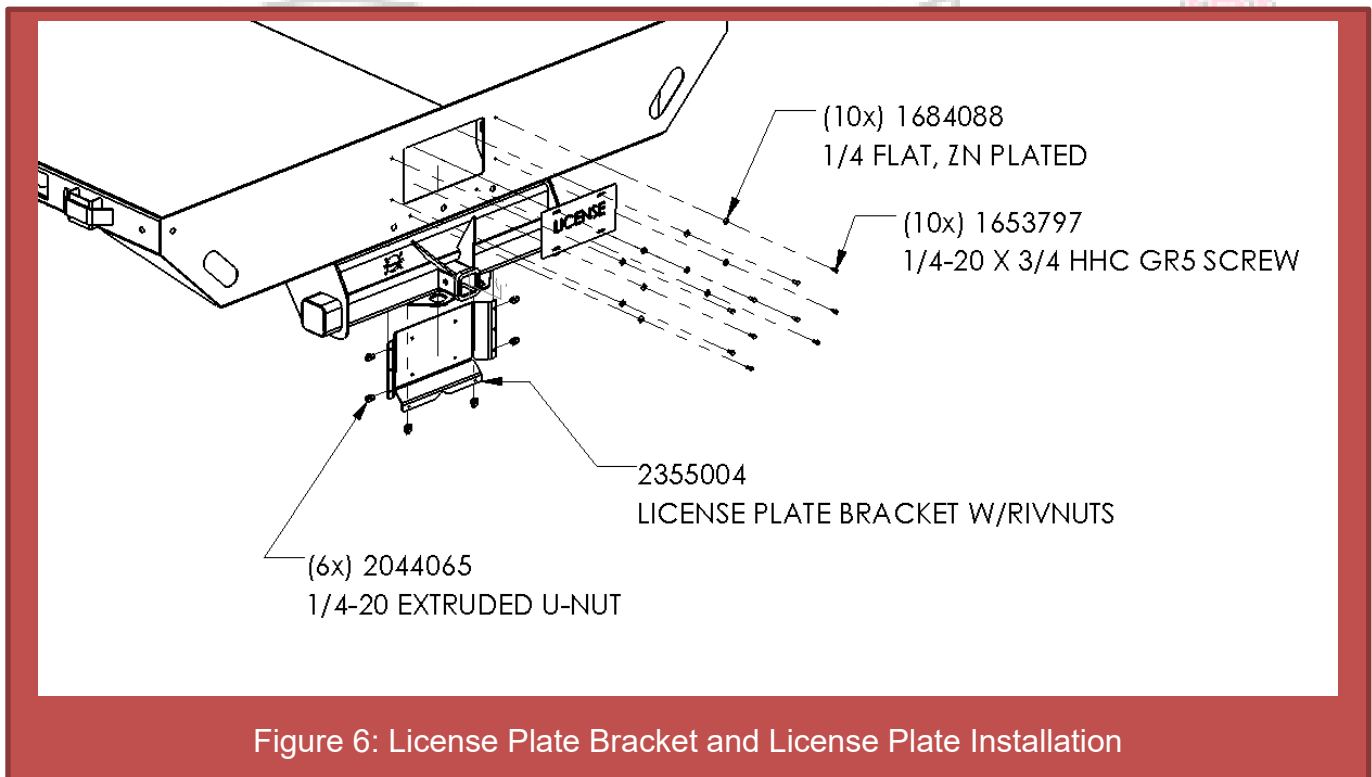

Rugby Manufacturing Rancher Manual

Fuel and DEF Inlet Bracket Installation

Tools Required: 1/4" Socket, Torque Wrench

NOTE: 6th generation Rugby Rancher Platforms can either have one or two cutouts on the side rail depending on the model.

NOTE: Rugby Manufacturing supplies one of the following with each 6th generation Rancher Platform:

- 2282788 – Bracket, Fuel Inlet PCBLK
- 2282787 – Bracket, DEF Inlet PCBLK
- 2305386 – Plate, DEF Fill Plug PCBLK

Install the Bracket(s)/Plate to the cutout(s) on the side rail as desired for your application. Refer to [Figure 7](#) for the installation of each Bracket/Plate. Refer to [Figure 2](#) for torque guidelines.

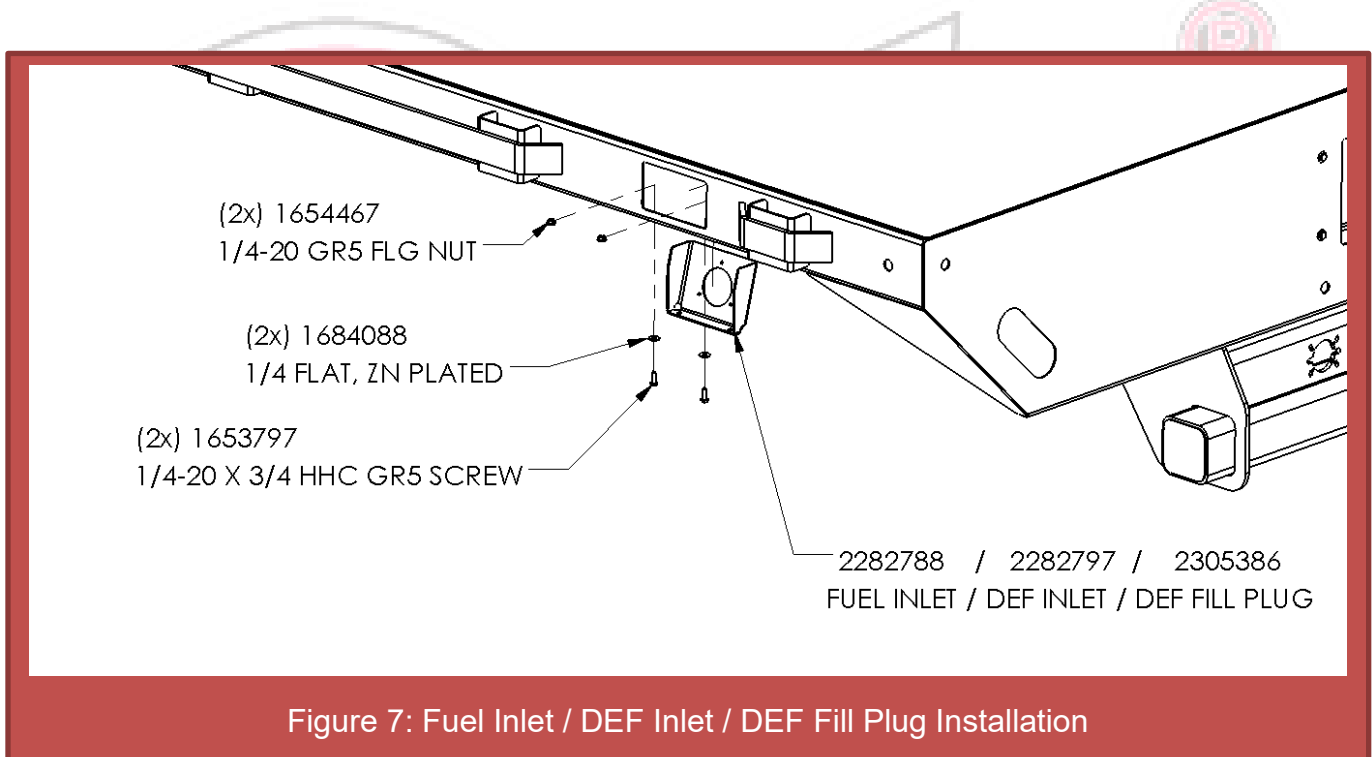

Rugby Manufacturing Rancher Manual

Installation to Truck Frame

NOTE: The following steps are to be followed as a general guideline when assembling and installing the Rancher body to the truck frame. Follow all truck manufacturer's recommendations for installing this body. The manufacturer's recommendations should be followed if there is a difference between them and this manual.

! WARNING

Do not weld to the vehicle frame. Do not drill any new holes in the top flange of the vehicle. Keep all drilled holes in the middle 1/3 of the vehicle frame. Doing otherwise will weaken the vehicle frame which can result in vehicle damage, injury, or death

NOTE: Refer to [Figure 8](#) for installation of the Rancher body to the truck frame. The Rancher body may be installed directly on top of the chassis rails, or it may be installed with a sleeper between the chassis and the body. A sleeper may be installed to allow the body to clear rivet heads or other obstructions found on the vehicle frame. Suitable sleepers may be constructed of wood, rubber, or steel. The sleeper should have a slight taper (to minimize stress on the chassis frame) which starts at the front of the Rancher frame.

! WARNING

Maintain at least 3" clearance between the front of the Rancher body and the back of the truck cab, or a clearance as specified by the chassis manufacturer. This is required to meet FMVSS regulations. If an adequate clearance is not maintained, the Rancher body may shift into the truck cab during an accident, resulting in injury or death.

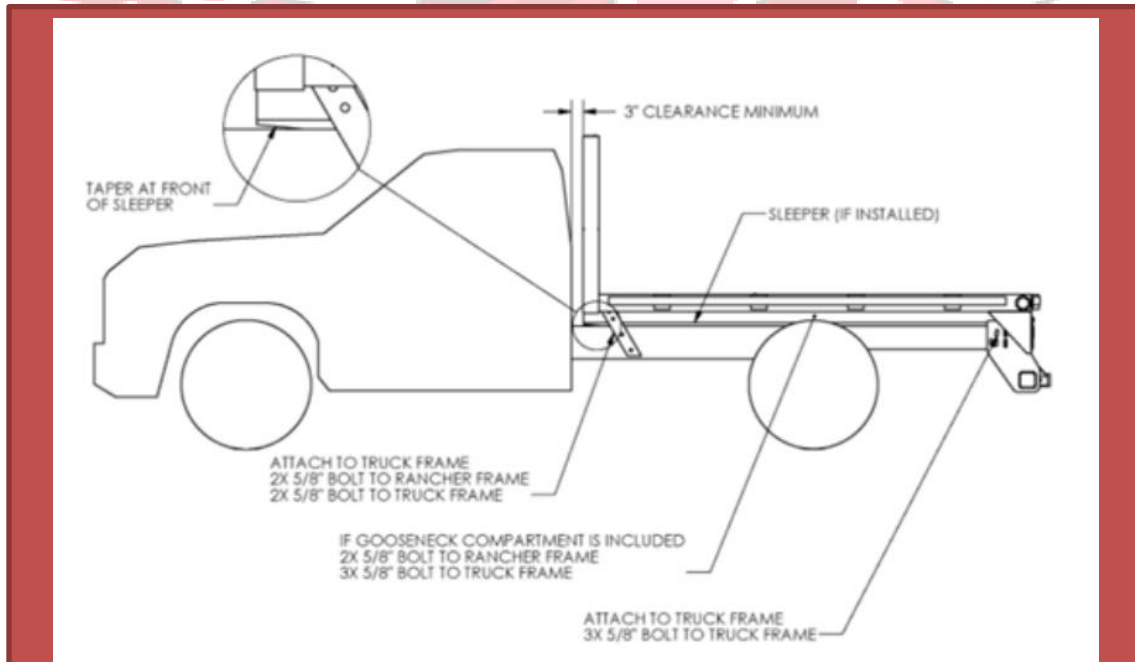

Figure 8: Installation to Truck Body. Cab to Bulkhead Spacing (3" Minimum)

Rugby Manufacturing Rancher Manual

Installation to Truck Frame cont.

NOTE: Rugby Manufacturing does not supply 5/8" Grade 8 Bolts, Nuts, or Washers or "Shear Plates" for installation of the Rancher body to the truck frame.

- 1) Use 5/8" diameter grade 8 bolts, nuts, and washers when attaching the Rancher body to the truck frame. Refer to [Figure 2](#) for torque guidelines. A "Shear Plate" installation is the typical method for securing the Rancher body to the truck frame. The Shear Plates should be a minimum of 1/4" X 3" steel plate.
- 2) The Front Shear Plate should be angled 45 to 60 degrees from the horizontal. The front shear plate should be located at least 4" from the front of the body to allow for frame flexing. The Front Shear Plate should be attached with a minimum of two (2x) 5/8" bolts to the truck frame rail, and two (2x) bolts to the Rancher frame.
- 3) The Rear Shear Plate should be attached to the truck frame with a minimum of three (3x) 5/8" bolts to the truck frame, and two (2x) 5/8" bolts to the Rancher frame. If the body was ordered with a Receiver Hitch, plates have already been welded onto the Rancher body in the Rear Shear Plate area. These eliminate the need for additional Rear Shear Plates. They should be attached to the truck frame with a minimum of three (3x) 5/8" bolts.
- 4) If the body includes a Gooseneck mount, then the body needs to be attached to the truck frame in the area of the Gooseneck. The Gooseneck Hitch assembly needs to be attached to the chassis frame. A Shear Plate should be attached to the truck frame with a minimum of three (3x) 5/8" bolts.
- 5) Follow manufacturer's recommendations for installing fuel filler and/or DEF fill components. Fuel fill components must be securely attached to the body.
- 6) Install and securely attach chain attachments as required.

NOTE: The Gooseneck Maximum Gross Trailer Weight for the Rancher body with a Gooseneck Compartment is 30,000 lbs. The rated vertical coupler load (tongue weight) is 7,500 lbs. This will be reduced if any other component of the towing system has a lower rating. If the truck, Gooseneck Ball, Safety Chains, Trailer Components, etc are rated lower than 30,000 lbs, the lowest rating should be used to determine the Maximum Gross Trailer Weight of the complete setup.

- 7) Grease Hitch Ball regularly, keep Gooseneck area free of dirt and debris. Check for: damaged parts before each use, bent or warped metal, cracked or failed welds, and excessive wear on ball. Check bolts before each use. If a bolt is loose, check for wear on the hole, or damaged to the surrounding metal. Do not use if anything is damaged. Tighten any loose bolts. Refer to [Figure 2](#) for torque guidelines.
- 8) If a Receiver Hitch is included with the Rancher body, the Maximum Gross Trailer Weight is 20,000 lbs with a Maximum Vertical Tongue Load of 2,000 lbs. Never exceed towing capacity of vehicle, Receiver Hitch, or any part of the towing system.

Rugby Manufacturing Rancher Manual

Optional & ordered separately: Mounting Kit 2493223 for GM Box Delete Truck Applications. Installation of kit to Truck Frame

- 1) When using the GM mounting kit, the “top hat” sections bolt to the existing bed mounting pads using the existing hardware

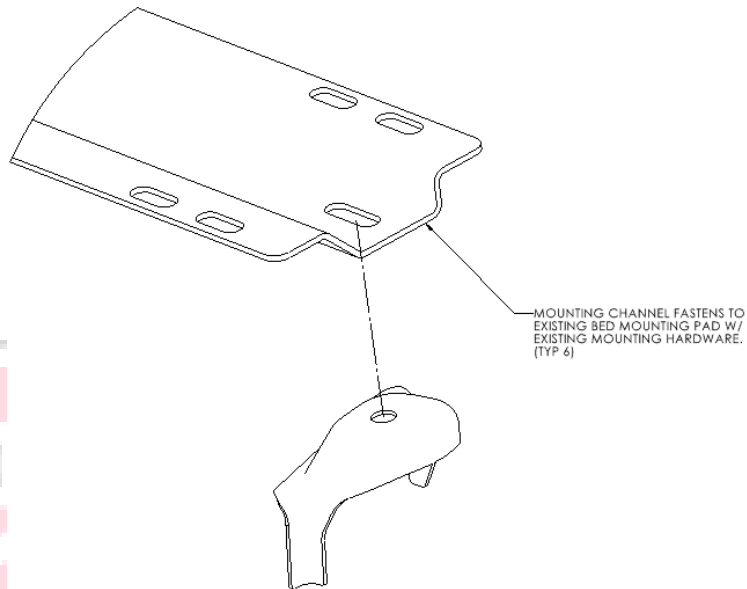

- 2) Angle mounts are bolted to the top hat section and then into the longills of the Rancher body using the supplied hardware.

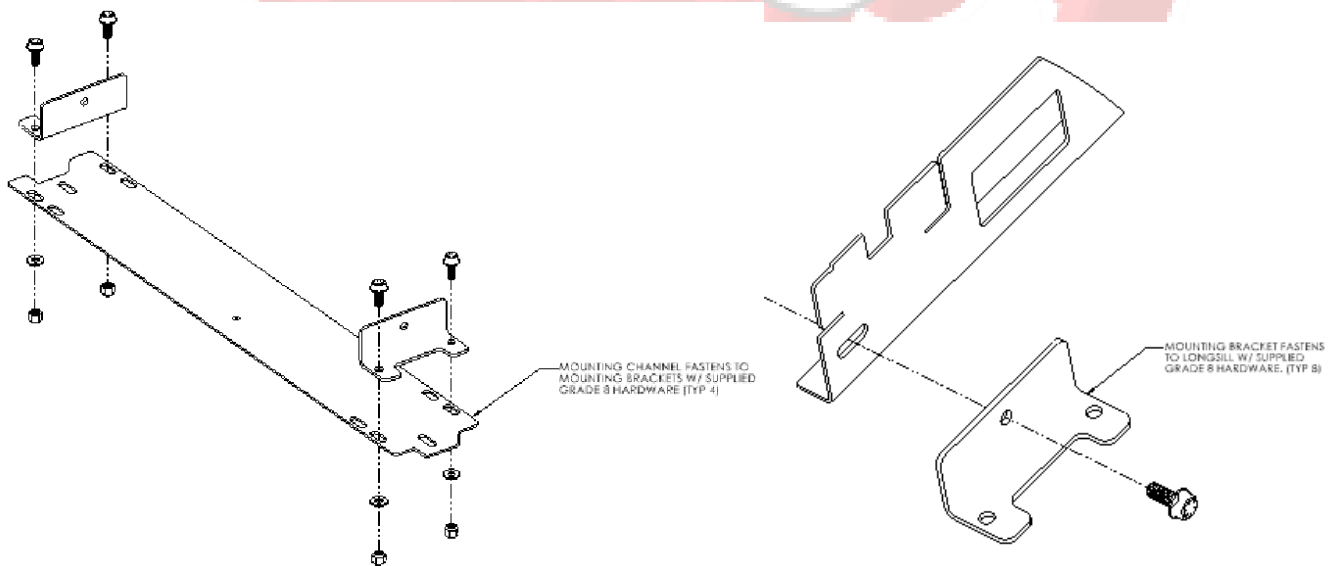

Rugby Manufacturing Rancher Manual

Optional & ordered separately: Mounting Kit 2493223 for GM Box Delete Truck Applications. Installation of kit to Truck Frame

- 3) The gooseneck supports are bolted to the truck frame and into the body longsills as shown.

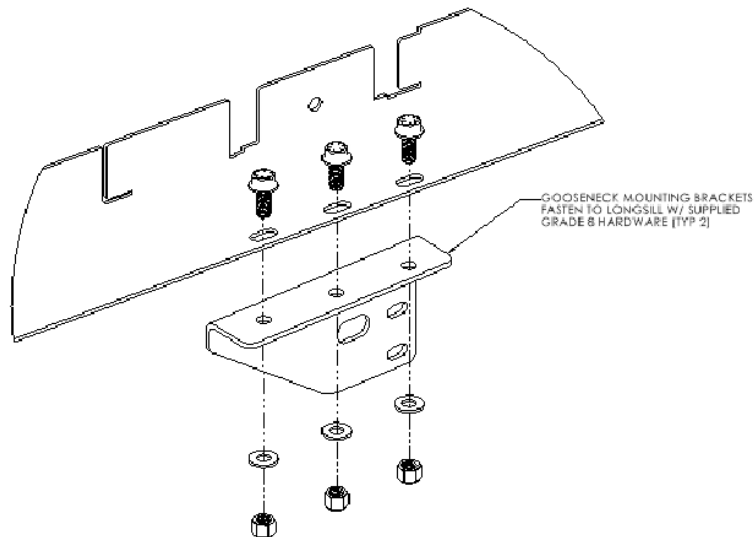

- 4) The rear mounting brackets are bolted into the truck frame as shown.

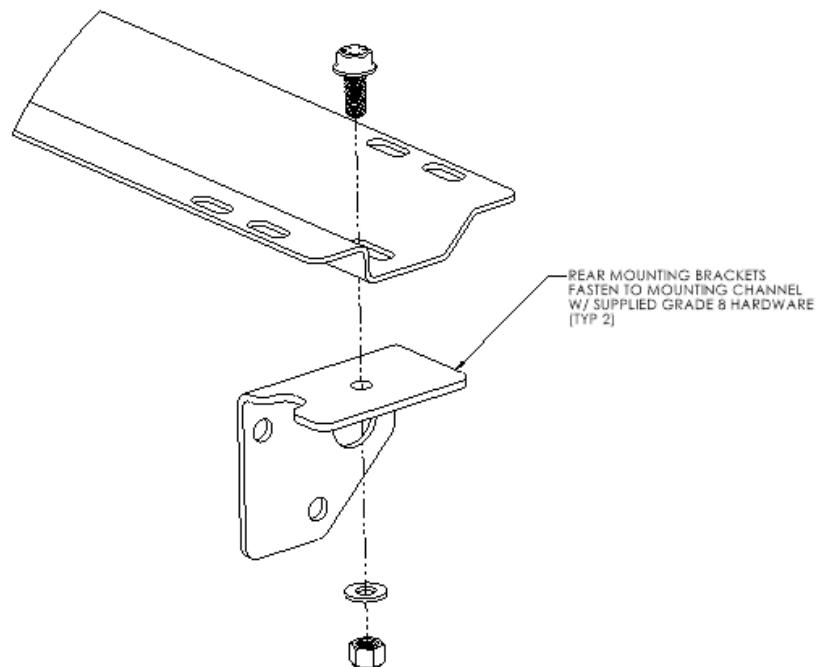

Rugby Manufacturing Rancher Manual

Optional & ordered separately: Mounting Kit 2493223 for GM Box Delete Truck Applications. Installation of kit to Truck Frame

ITEM	PART NUMBER	DESCRIPTION	QTY
1	2493210	CHANNEL, RANCHER MOUNTING FRONT PCBLK	3
2	2493212	CHANNEL, RANCHER MOUNTING REAR PCBLK	1
3	2493214	BRACKET, RANCHER MOUNTING PCBLK	8
4	2493220	BRACKET, RANCHER MOUNTING REAR LEFT PCBLK	1
5	2493222	BRACKET, RANCHER MOUNTING REAR RIGHT PCBLK	1
6	2493216	BRACKET, RANCHER GOOSENECK MOUNTING LEFT PCBLK	1
7	2493218	BRACKET, RANCHER GOOSENECK MOUNTING RIGHT PCBLK	1
8	2493231	BOLT, 5/8-11 X 1-1/2 FLANGE GR8 STL YZ	30
9	2493232	NUT, 5/8-11 NYLOCK GR8 STL YZ	30
10	2493233	WASHER, 5/8 GR8 STL YZ	30

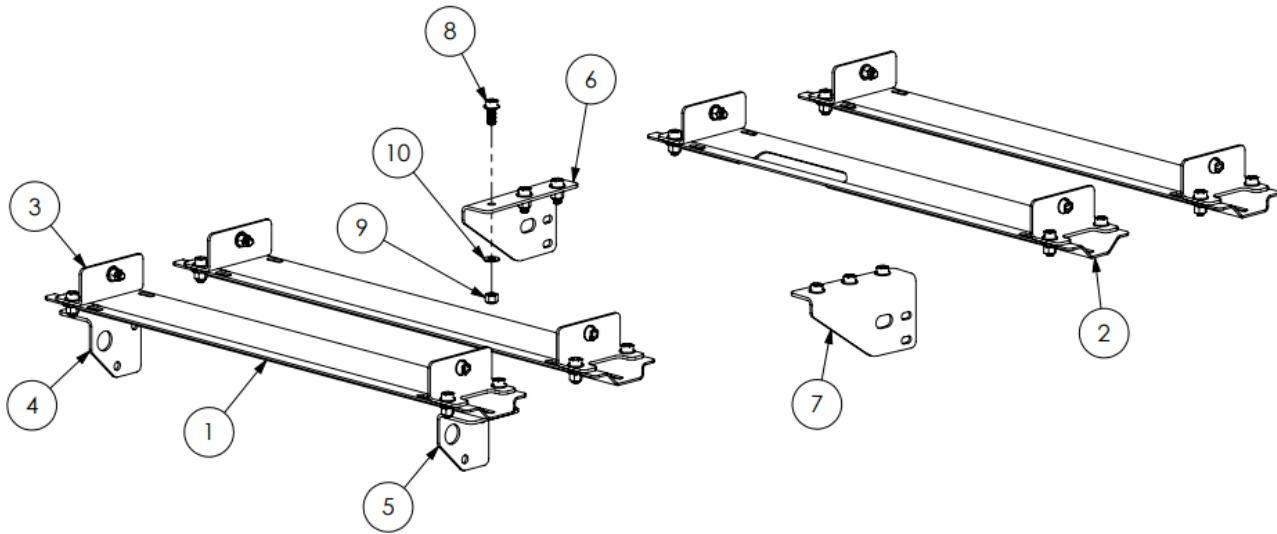

Rugby Manufacturing Rancher Manual

Ram Mounting

2682909 KIT, RA BD MNTG RAM W/GN HARDWARE

ITEM	PART #	DESCRIPTION	QTY
1	2682912	BRACKET, RA BD RAM GOOSENECK L PCBLK	1
2	2682914	BRACKET, RA BD RAM GOOSENECK R PCBLK	1
3	2682920	SPACER, RA BD RAM 4"X3-5/8" 1/4 PCBLK	4
4	2682922	SPACER, RA BD RAM 5"X2" 10GA PCBLK	2
5	2493214	BRACKET, RANCHER MOUNTNG PCBLK	6
6	2660421	ANGLE, RA BD FORD PCBLK	2
7	2516889	BOLT, 1/2"-13 X 1-1/2" HEX GR8 STL YZ	28
8	2516890	WASHER, 1/2 GR8 STL YZ	56
9	1642984	NUT, 1/2-13 NYLOCK - NE GR8 STL	28

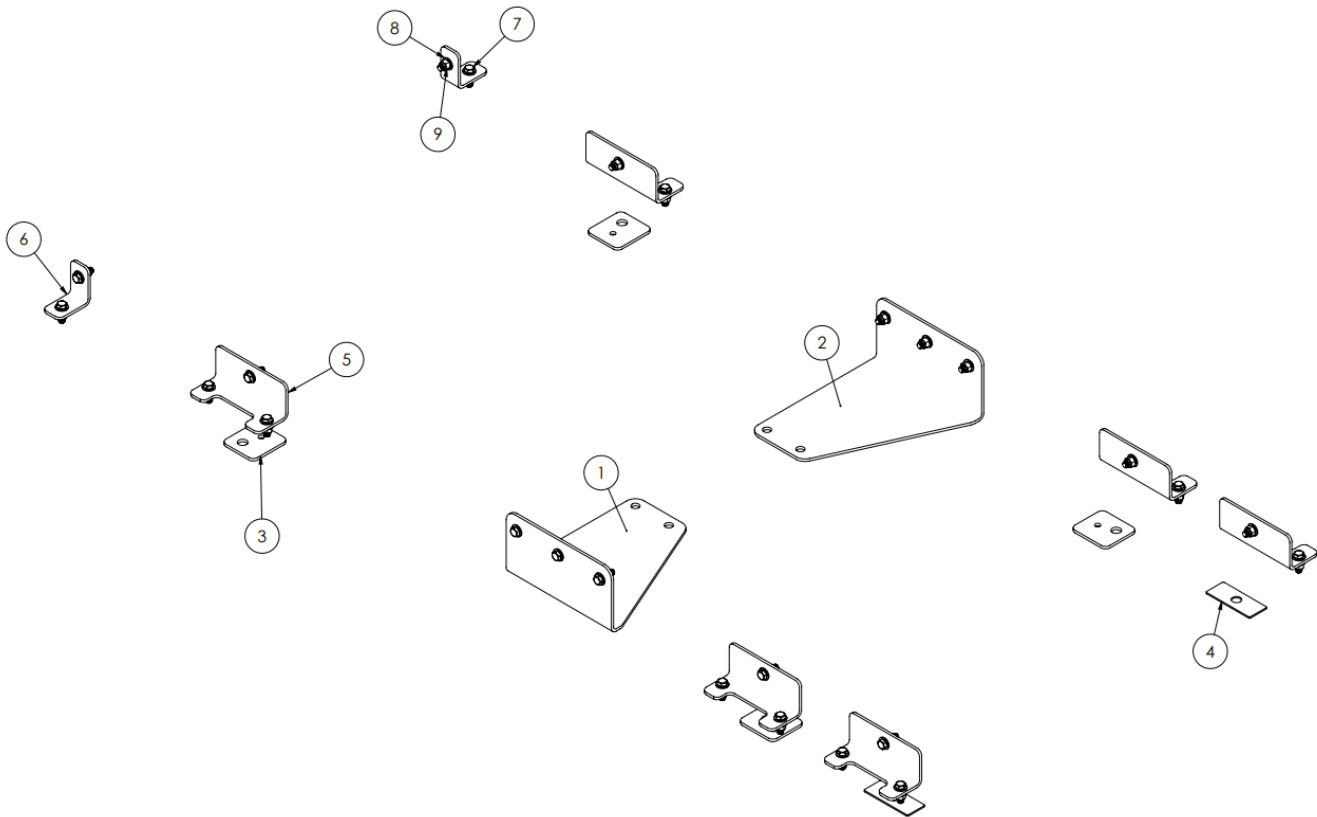

2682910 BUNDLE, RA BD MNTG RAM W/GN TOPHAT

ITEM	PART #	DESCRIPTION	QTY
1	2682916	CHANNEL, RA BD RAM FRONT PCBLK	1
2	2682918	CHANNEL, RA BD RAM REAR PCBLK	3

Rugby Manufacturing Rancher Manual

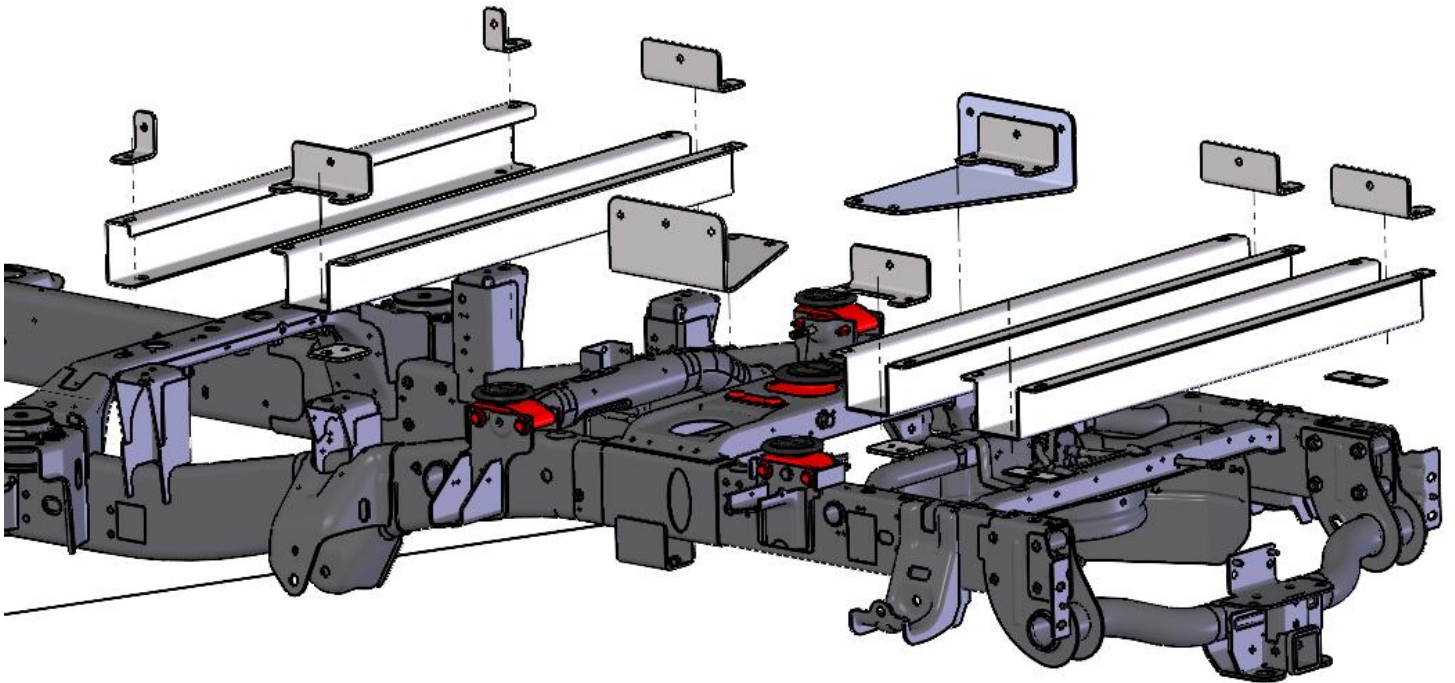
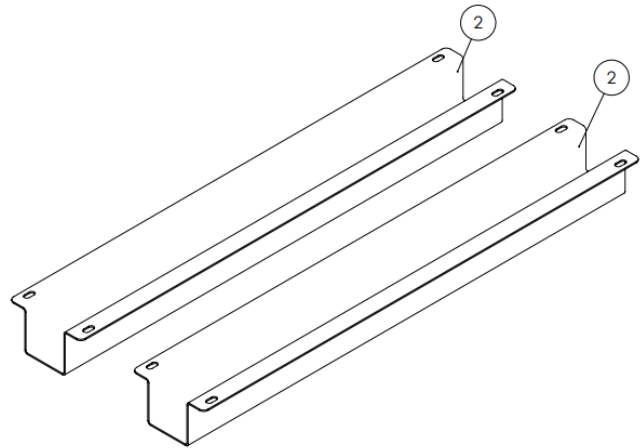
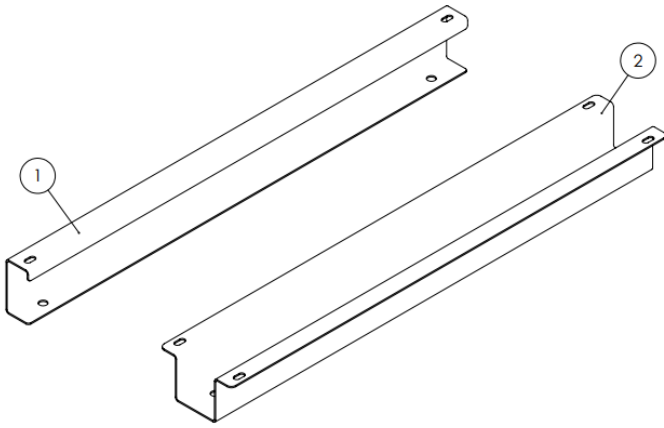

Rugby Manufacturing Rancher Manual

Ford Mounting

2660414 KIT, RA BD MNTG FORD W/GN HARDWARE

ITEM	PART #	DESCRIPTION	QTY
1	2493213	BRACKET, RANCHER MOUNTING	6
2	2660421	ANGLE, RA BD FORD PCBLK	2
3	2660423	BRACKET, RA BD FORD GOOSENECK PCBLK	2
4	2660436	SPACER, RA BD FORD 6"X8" 7GA PCBLK	2
5	2660438	SPACER, RA BD FORD 2"X2" 5/16 PCBLK	4
6	2660440	SPACER, RA BD FORD 2"X6.5" 7GA PCBLK	2
7	2516889	BOLT, 1/2"-13 X 1-1/2" HEX GR8 STL YZ	28
8	2516890	WASHER, 1/2 GR8 STL YZ	56
9	1642984	NUT, 1/2-13 NYLOCK - NE GR8 STL	28
10	2660417	CHANNEL, RA BD FORD FRONT PCBLK	3
11	2660419	CHANNEL, RA BD FORD REAR PCBLK	1

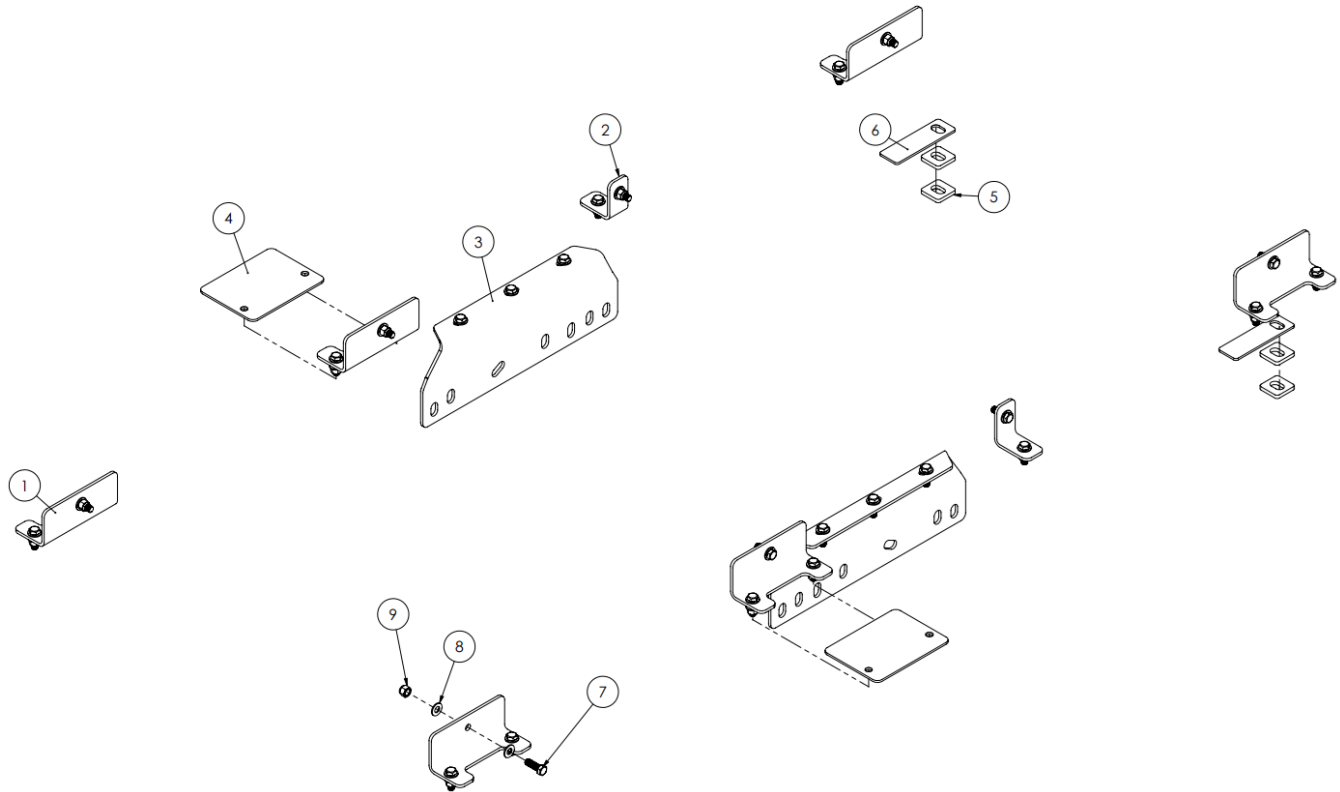

2660415 BUNDLE, RA BD MNTG FORD W/GN TOPHAT

ITEM	PART NUMBER	DESCRIPTION	QTY
1	2660417	CHANNEL, RA BD FORD FRONT PCBLK	3
2	2660419	CHANNEL, RA BD FORD REAR PCBLK	1

Rugby Manufacturing Rancher Manual

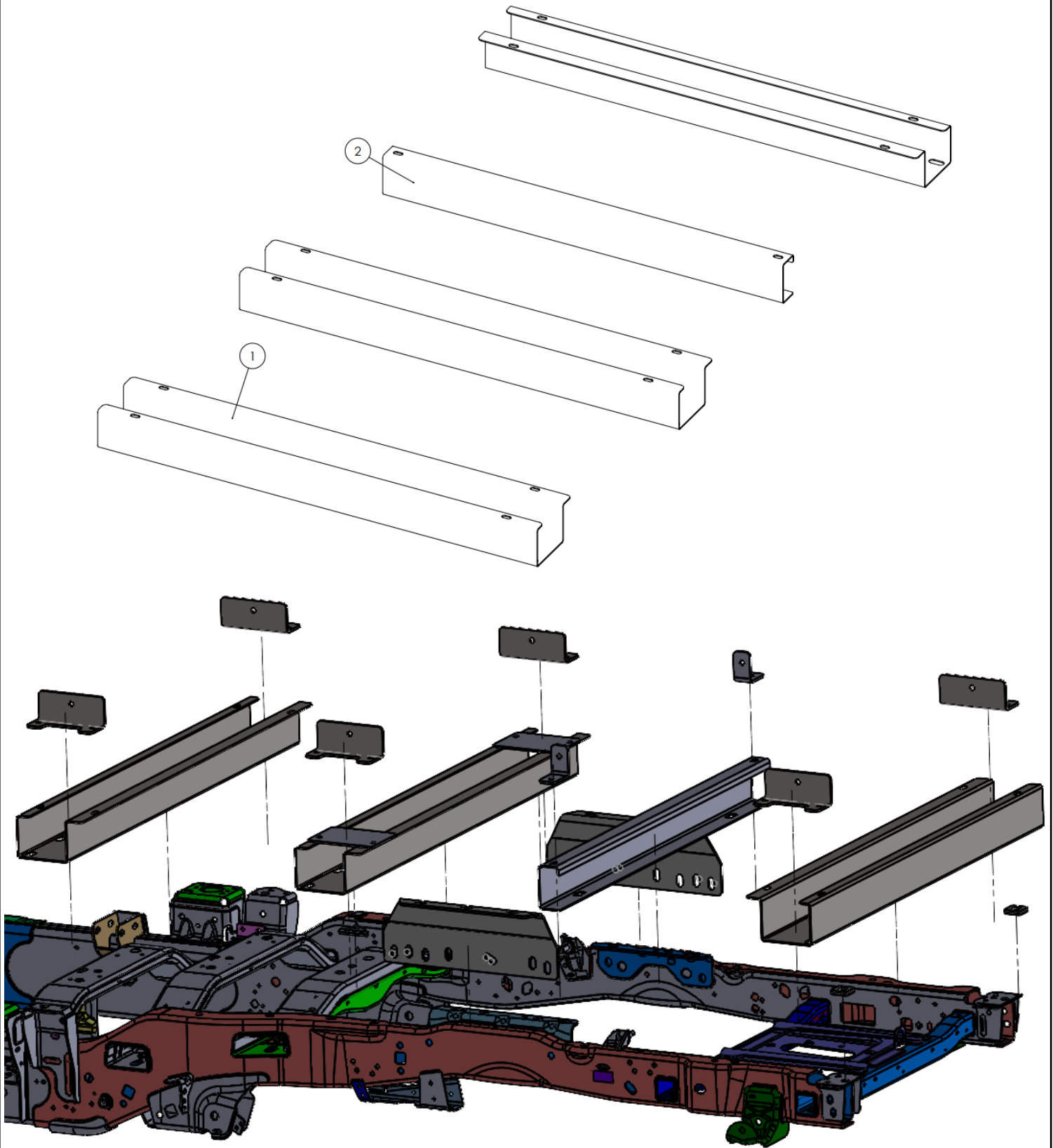

Rugby Manufacturing Rancher Manual

Lights & Decals

NOTE: 6th Generation Rugby Ranchers come with lights and decals installed. Use this section as a reference if replacements are needed.

NOTE: 96" wide Rancher bodies require amber LED lamps on both sides of the Front of the Rancher body to comply with the Code of Federal Regulations: Title 49, Vol. 5.

Refer to Figure 9 for Light and Decal Locations

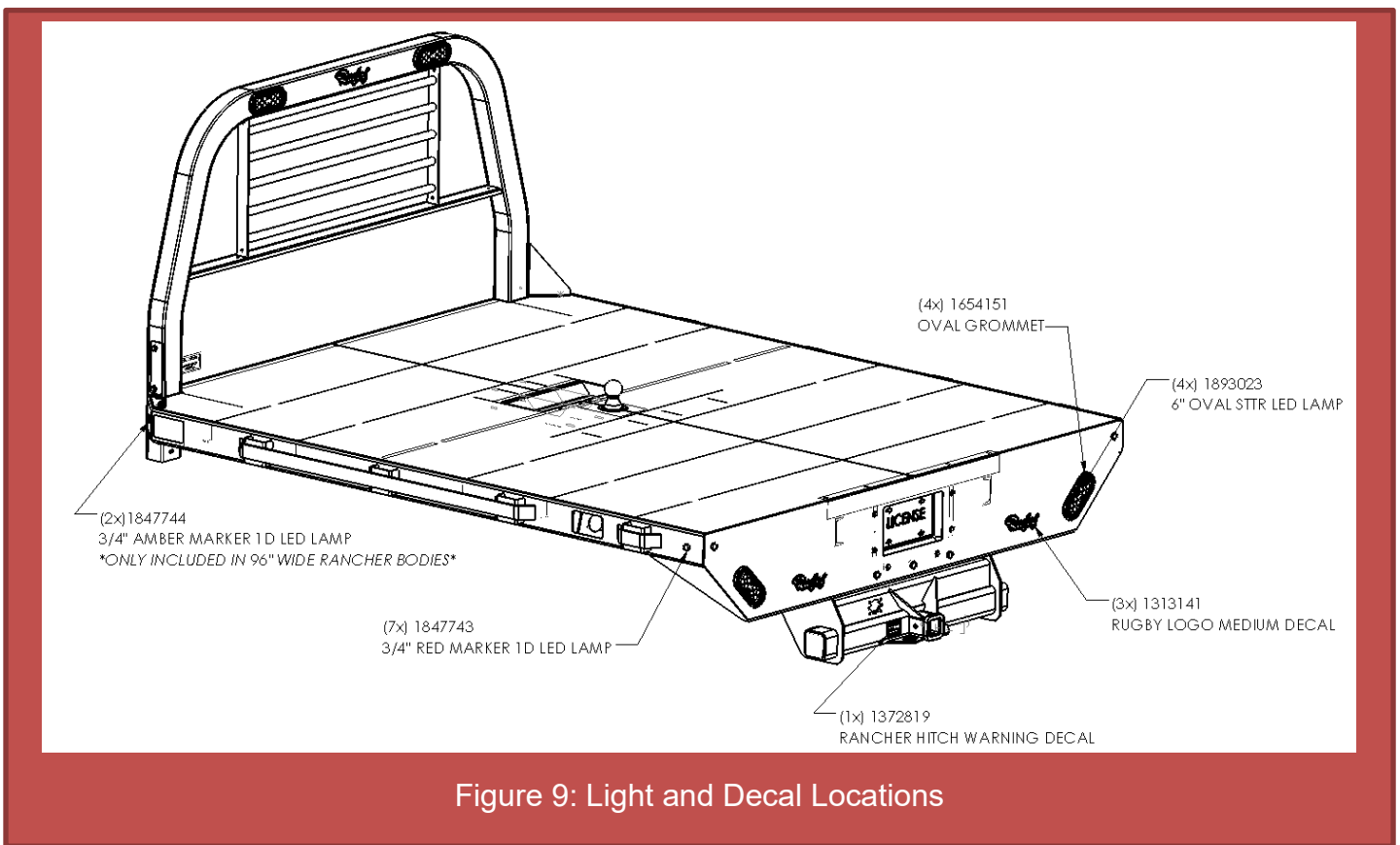

Rugby Manufacturing Rancher Manual

Maintenance & Operation

NOTE: Follow good safety practices and be aware of your surroundings when operating this product. Read and follow the general warnings found at the beginning of this manual.

NOTE: If a receiver hitch is included with the Rancher body, the Maximum Gross Trailer Weight is 20,000 lbs with a Maximum Vertical Tongue Load of 2,000 lbs. Never exceed towing capacity of the vehicle, receiver hitch, or any part of the towing system.

NOTE: The Gooseneck Maximum Gross Weight for the Rancher body with a Gooseneck Compartment is 30,000 lbs. The rated vertical coupler load (tongue weight) is 7,500 lbs. This will be reduced if any other component of the towing system has a lower rating. If the truck, gooseneck ball, safety chains, trailer components, etc are rated lower than 30,000 lbs, the lowest rating should be used to determine the Maximum Gross Trailer Weight of the complete setup.

WARNING

Overloading of a vehicle can cause vehicle component damage or an accident which may cause injury or death. Never exceed the Gross Vehicle Weight (GVWR) or the Gross Axle Weight (GAWR) rating or Gross Combined Vehicle Rating (GCWR) of your vehicle.

FASTENERS: Check that all bolts and nuts securing the body to the frame are tightened according to the torque guidelines provided in [Figure 2](#). Check these every time the vehicle is serviced, or at least once a year. Initially recheck these within 1 month after the body is installed.

LIGHTING: Inspect the lighting periodically for proper operation. Replace or repair any damaged wiring, broken lenses, broken bulbs, or burnt out bulbs. Proper lighting is critical to the safe operation of the vehicle. Install the lights as shown in [Figure 9](#), then attach wiring harnesses.

DECALS: Decals must be present and readable on the body. If any decals are missing or damaged, they must be replaced. To obtain replacement decals, contact your "Rugby" dealer.

WARNING

Missing or damaged decals can lead to accidents that may cause serious injuries or death.